

LOCKHART SHIRE



Home of the True Country Spirit!

Residents Kit



Welcome to Lockhart Shire

Lockhart Council would like to welcome you to our beautiful Shire.

Surrounded by natural beauty, Lockhart Shire captures the essence of country life and is a vibrant, safe and growing place to live, work and raise a family. There are an array of lifestyle choices on offer in our wonderful Shire, from welcoming heritage towns and villages to wide open spaces and the great outdoors.

The Shire has a rich history, healthy climate and a prosperous economy. With affordable housing, quality education and plenty of opportunities for the motivated, the Shire offers great schools, hospitals, childcare centres and friendly communities ready to welcome you.

Covering an area of 2942.43 square kilometres, Lockhart Shire offers you every possible lifestyle option from serviced urban residential properties to rural and rural residential acreage.

The major townships of Lockhart Shire are Lockhart and The Rock and the smaller villages of Yerong Creek, Pleasant Hills and Milbrulong. We are also well situated between two vibrant regional hubs, Wagga Wagga and Albury-Wodonga.

In this information package you can find information about our Council, our environment, development, community facilities and services and other relevant details about Lockhart Shire.

If we can assist you further in any way, please contact Council.

Lockhart Shire Council

65 Green Street (PO BOX 21) Lockhart NSW 2656

Phone: 02 69205305

Email: mail@lockhart.nsw.gov.au

Websites: www.lockhart.nsw.gov.au

Lockhart Facts

Population: 3350

Housing: (median price: \$160,000)

Location: Sydney 500km, Melbourne 400km, Canberra 300km

Climate: Lockhart Shire enjoys warm summers with an average daily temperature of 31°C, while winters are mild with average highs of 14°C. Long summer days suited to a fantastic range of outdoor activities are followed by stunning sunsets and star studded nights, while winter is a great time for rugging up and heading into nature, including easy day trips to the NSW and Victoria ski fields.

Economy: Lockhart Shire is a thriving, prosperous agricultural centre supported by long established businesses, the value adding in secondary industries and the network of service industries. The new Lockhart Industrial Park has assisted in the development of further businesses in the region, as will the new Industrial Park at The Rock, which is also supported by a strong primary industry and value add services. An enthusiastic Council and a warm and welcoming community ensure strong support for new business and enterprises.

Heritage based and Eco-Tourism are beginning to play an important role in the economy, with festivals and events having seen a strong positive growth over recent years. Open for business on the weekend, Lockhart attracts many passing visitors and an increasing number of day trippers. The Rock's growth trends reflect an increase in lifestyle blocks, with residents moving from Wagga and district to settle in a country town. This growth reflects the Shire's popularity both as a place of residence, business and short term visits.

Facilities:

- Automotive Services
- Banks and Credit Union
- Builders and Trades
- Cafes and Restaurants
- Caravan Parks
- Child Care
- Education
- Hair and Beauty
- Health and Wellbeing
- Hospital
- Legal and Accounting Services
- Pharmacies
- Post Offices
- Pubs and Clubs
- Real Estate Agents
- Retail and Wholesalers
- Service Stations
- Sports and Recreation
- Supermarkets
- Swimming Pools
- Transport, Storage and Freight.

Towns and Villages

Lockhart: A thriving little market town that acts as a business centre for surrounding farms and villages. The town is a tourist haven, with heritage verandahs, etched pavers, a farm art sculpture trail and Australia's only wool art gallery, whilst the recently opened Industrial Park has brought new business and economy to the town.

The Rock: A quaint railway town with strong community values and a great opportunity for growth and expansion. Located on the Olympic Highway between Wagga and Albury, The Rock is emerging as a popular lifestyle choice for those wanting to escape city living while maintaining easy access to an extensive range of amenities.

Yerong Creek: Known as the 'Vintage Village', Yerong Creek is the oldest village in the Lockhart Shire. Settled in the 1870's, Yerong Creek provides a great opportunity to get away from the hustle and bustle of city life with large, affordable lifestyle blocks and an ideal location on the Olympic Highway between Wagga and Albury, the region's two largest city.

Pleasant Hills: The aptly named village of Pleasant Hills is a hidden treasure, combining a tranquil lifestyle with a vibrant community. The impressive old buildings are a living history of the strong Lutheran past, from the wattle and daub Church to the incredible workmanship of the Public Hall and the Pleasant Hills Community Hotel which is still in use today.

The Great Outdoors

The Rock Nature Reserve: Towering high above the plains, The Rock Hill makes for a great day out. Take a picnic and hike to the top for stunning views, or meander along the tracks at the base of the Hill and enjoy fantastic fauna and flora. You never know which of our great native animals will pass you by.

Galore Hill: Another natural wonder in Lockhart Shire, Galore Hill offers fantastic walking, cycling, horse riding and rock climbing. Drive to the Summit and climb the Tower for impressive views over the surrounding landscape or enjoy a BBQ at the Saddle while the kids make the most of the play equipment. Kangaroos, wallabies, echidnas and black cockatoos are just some of the amazing wildlife regularly seen.



Education and Childcare

Lockhart Shire has three Primary Schools, two Village Schools, two High Schools (one to Year 10, one to Year 12). School buses travel daily from Lockhart and The Rock to Wagga, and boarding school transport also runs to ensure weekends at home. Excellent child care facilities are available in Pleasant Hill, The Rock and Lockhart.

Lockhart Central School: www.lockhart-c.schools.nsw.edu.au/

Pleasant Hills Public School: www.pleasanthi-p.schools.nsw.edu.au/

St Joseph's School, Lockhart: web.sjloww.catholic.edu.au/

The Rock Central School: www.therock-c.schools.nsw.edu.au/

Yerong Creek Public School: www.yerongck-p.schools.nsw.edu.au/

Housing

The affordable price of housing and choice of residential and lifestyle blocks in Lockhart Shire opens up all sorts of opportunities on the home front. It means you can have your dream home without missing out on life's little extras.

The average price for a three bedroom home averages \$170,000, with an average rental of \$180 per week.

Establish a home today and raise your family in a friendly rural community with the township offering local hospital, doctors, police, ambulance, senior and primary schools, banking and shopping.

There are currently two residential subdivisions in Lockhart, with 36 lot sizes ranging from 671m² to 1796m². Lots are fully serviced including sealed roads, electricity, water, sewer and telecommunications all available.

Prices for these subdivisions range start at \$27,000. For further information on residential blocks for sale by Lockhart Shire Council please call Luke Foley at John Mooney Real Estate on (02) 6921 1255.

The Rock and Yerong Creek also have new subdivisions with competitive locations, lot sizes and affordability.

For new and existing house opportunities visit www.realestate.com.au, which also includes details on the following subdivisions:

- Green Street West Residential Blocks, Lockhart
- Bond Street Lifestyle Blocks, Lockhart
- Plunkett Street Lifestyle Blocks, Yerong Creek
- Residential Blocks coming soon, The Rock.

Lockhart Industrial Park

Set in the centre of a prosperous agricultural area, Lockhart Industrial Park is a thriving enterprise and is testimony to Lockhart Shire's commitment to growth and opportunity. The site is situated within the Lockhart plains and is predominantly surrounded by agricultural land, with township boundary to the west and surrounding land uses comprising of board-acre agriculture and grazing enterprises.

Following the successful sale of Stage 1 at Lockhart Industrial Park, the Stage 2 industrial allotments have now been released. Stage 2 consists of 10 vacant lots ranging in size between 4,106m – 5,668m, with an opportunity to acquire fully serviced industrial land for **\$12 sq metre** plus GST.

Prices for allotments:

LOT 13 5000m	\$66,000
LOT 21 5006m	\$66,000
LOT 22 5003m	\$66,000
LOT 23 5000m	\$66,000
LOT 24 5000m	\$66,000
LOT 25 4106m	\$55,000
LOT 26 5668m	\$78,000
LOT 27 5003m	\$66,000
LOT 28 5003m	\$66,000
LOT 29 5004m	\$66,000

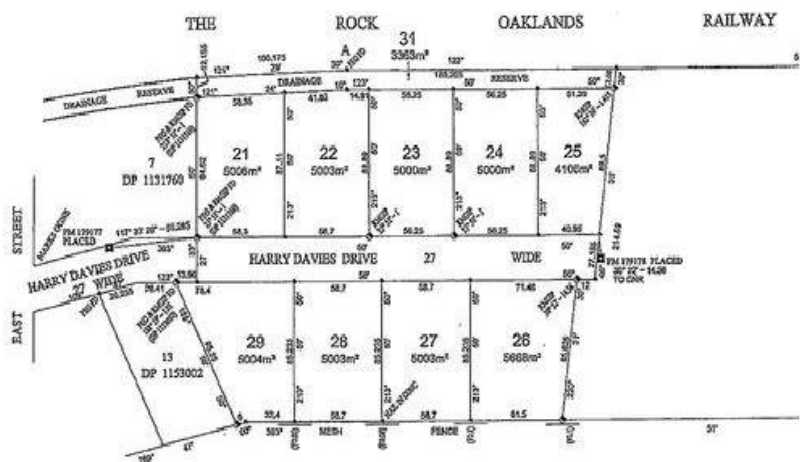

Key infrastructure includes:

- Connection to major arterial roads and regional roads:
 - Albury Road
 - Collingullie/Wagga Road
 - Jerilderie Road
 - The Rock Road
 - Narrandera Road
 - Urana Road.
- The Albury Road provides a direct route between Albury and south western slopes region; access to the Murray Valley Highway leading to the southern board acre and irrigation area including the Goulbourn Valley irrigation district and Melbourne.
- Situated 45 minutes from Wagga, via the Wagga/ Collingullie Road.
- The Southern Railway Line, linking Sydney and Melbourne via The Rock, has an access branch line that services Lockhart and Boree Creek grain terminals. This railway line runs alongside the Industrial Park and is approximately 40 meters to the northern allotments.
- Lockhart airstrip is located 5 kilometres from the Industrial Park.

New Release Industrial Land

NOW SELLING

\$12m² +GST

For further information on Industrial Land for Sale in Lockhart Shire please call Luke Foley at John Mooney Real Estate on (02) 6921 1255.

Industrial Land at The Rock

Following an amendment to the Lockhart Local Environmental Plan 2012, an industrial area at The Rock has been created to allow for potential future growth. The area, zoned as IN-1 General Industrial, is approximately 15Ha in size, and currently privately owned by a long-term resident of The Rock. The land was formerly zoned RU-1 Primary Production, and is thus undeveloped farming land.

The newly zoned land is directly adjacent to the Olympic Highway, a major route between the larger regional centres of Albury-Wodonga and Wagga Wagga, while also providing an essential connection from Victoria to the vast Riverina and Central NSW. Directly to the north of the industrial-zoned land is a an access road easement of 60m in width from the Olympic Highway, with great potential for improvement in regards to turning lanes, kerb and gutter and formed seal.

The Sydney-Melbourne rail line also runs parallel to the property boundary, with a secondary line branch off approximately 100m to the northern boundary.



Careers

Lockhart Shire is a rural service area with a healthy local economy and a progressive approach to community development. Lockhart Shire Council is the main employer however opportunities also exist in the Health & Medical profession, agricultural industries and to a lesser degree in retail. There is a modest but ongoing demand for employees in its trades and services sectors.

A wide range of business opportunities exist in the Lockhart Shire, particularly in the growing communities of The Rock and Lockhart. As well as shop front opportunities, Lockhart has a progressive Industrial Park which has recently released Stage 2. With low establishment costs, the blocks are priced at \$12 m² plus GST. The Rock, which also offers shop front opportunities, will be opening up Stage 1 of their Industrial Park shortly.

Health and Medical

There is a high standard of medical services and facilities available throughout Lockhart Shire including a modern and efficient Hospital, Medical Centres, Pharmacies, various Aged Care accommodation and regular visits from a variety of specialists including dentist, optometrist. A number of ancillary services are also available including Community Nurses and Home Nursing Services. Our Aged Care Accommodation includes:

Magnolia Lodge, Lockhart:

9 self contained units within easy walking distance to the town centre and facilities, yet pleasantly located in country surroundings for independent living

Woodhaven Aged Care Hostel, Lockhart:

22 bed facility in well presented surroundings providing general and special needs aged care

Emily Gardens, The Rock:

30 bed facility in well presented surroundings with country views, providing general and special needs aged care

Sports and Recreation

Like sports? Lockhart Shire has sports for every season. Football, tennis, cricket, squash, netball, cycling, mountain biking, bowling, athletics, abseiling, rock climbing, hang gliding, swimming pools, golf, fishing, horse riding and more. We're also within easy driving distance of fantastic water skiing and the country's only snow fields.

Cultural Heritage

This district is part of Wiradjuri country, one of the largest Aboriginal language groups in Australia. Lockhart Shire district has acknowledged the Indigenous ownership in some settlement names. Urangeline, the name of an original pastoral station and one of the settlements in the Lockhart Shire, is named after an aboriginal elder from the district. The Rock Hill, named Kengal by the Wiradjuri people, is the best known land form in the Riverina. Renowned for the majestic land form, The Rock Hill has influenced the development of the township and continues its influence today.

The Shire was a favourite haunt of bushrangers who were active in the 1860's, including 'Mad Dog Morgan' (Dan Morgan) 'Blue Cap' (Robert Cotterill) and others who were active in the area.

Since settlement, Lockhart Shire has relied on agriculture as its main industry. More Historical Information is available at the Greens Gunyah Museum which has an extensive range of historical artefacts, photographs and machinery on display.

Entertainment and Culture

Sculpture trails, wool art, local galleries, unique performances and a fantastic Spirit of the Land Festival are just a taste of what's available in Lockhart Shire's growing Arts scene. We also have a host of groups and events throughout the Shire covering a vast range of hobbies and interests. New activities are always encouraged and enthusiastically supported by both the community and Council.



Things to See & Do

Surrounded by fertile agricultural land and great natural beauty, the thriving towns of Lockhart and The Rock, together with the villages of Yerong Creek and Pleasant Hills, offer a host of unique experiences.

For art lovers, the Verandah Town of Lockhart is a charming surprise. Wide shady verandahs, award winning sculptures and the impressive Doris Golder Wool Art Gallery are just a few of the treasures, as are the 400 images etched in the pavers as a testimony to the Shire's long and proud history. With weekend shopping available, experience the friendly service and easy parking, or enjoy coffee and a relaxed lunch in one of Lockhart's many eateries.

Following the lively Lockhart Picnic Races on 10 October, an annual highlight in Lockhart is the amazing Spirit of the Land Festival, hosted on the weekend of 11 and 12 October 2014. Drawing visitors from all over the nation, the Festival includes remarkable farm art sculptures, a great array of entertainment, markets, food and attractions.

While at The Rock, walk along The Avenue and delight in the magnificent canopy of Kurrajong trees, each one planted in honour of local soldiers who marched off to fight in World War 1. Enjoy lunch in the café, picnic in one of the pretty parks, complete with play equipment, picnic benches and toilets, or take a wander through the antique and craft shops.

Yerong Creek is Lockhart Shire's oldest village and is the site of Noske's Chinese Crossing, a rare remaining example of functional stone work carried out by Chinese migrants. Built in the early 1880s as a dam wall to accumulate water for the growing of vegetables and option, Norske's Crossing still serves as a carriageway across Yerong Creek to this day.

Pleasant Hills is a vibrant community steeped in old impressionable buildings with such a strong Lutheran heritage that the street signs feature in both English and German. The flora of the Esplanade in the center of the village is very pretty, and the public hall built in 1912 features a remarkable mural, however the focal point of the village is the Pleasant Hills Hotel, NSW's first community owned hotel.

For more information on attractions and events go to visitlockhartshire.com.au.

Council Information

Corporate Structure

Elected Representatives and Professional Staff

General Manager

Director of Engineering

Director of Corporate Services

Councillors

Lockhart Shire elects nine Councillors for a 4-year term in line with the Local Government Act. Their role is to develop policy and strategic direction. Their responsibilities to the Shire are to ensure Council's policies and objectives result in a Management Plan consistent with its broader vision and obligations to the community. Council meetings are held on the 3rd Monday of each month.

Council Meetings

Council meetings are held at 5.00pm on the 3rd Monday of each month in the Council Chambers, 65 Green Street Lockhart. The business papers and minutes are published on the Council Website.

Council meetings:

- Seal with reports and recommendations from its committees.
- Councillors can also raise concerns they have or that have been brought to their attention by residents of the Shire. These are either put into action or referred to the relevant section of Council for determination.
- For some confidential matters the Council retires "closed committee" and the public is asked to leave the Chambers.

Our Environment

Animal Registration - FAQ

Companion Animals Act has laws about control and penalty. In addition, from 1 July, 1999 the system of registration has changed to 'lifetime' registration through micro-chipping. Cats as well as dogs will need to be registered. Brochures outlining the new Companion Animals Act are available free of charge from Council.

How much will lifetime registration for a cat or dog cost?

<i>Entire (Not de-sexed) cat or dog</i>	<i>\$150.00</i>
<i>Entire cat or dog owned by a registered breeder</i>	<i>\$40.00</i>
<i>De-sexed cat or dog</i>	<i>\$40.00</i>
<i>De-sexed cat or dog owned by a pensioner</i>	<i>\$15.00</i>

Does my cat have to be kept inside?

No. The Companion Animals Act does not contain any requirement for a cat curfew or for cats to be kept inside. However cat owners are encouraged to keep them in at night.

What do I have to do to when exercising my dogs?

Dogs must be on a leash and under the control of a competent person at all times while in a public place. A number of off leash areas are available for use.

What happens if my animal is taken to the pound?

If the animal is wearing an appropriate identification tag, or is micro-chipped the owner will be notified of its impoundment. A fee is charged for the animal to be released.

What can I do about nuisance dogs?

Council can issue a Nuisance Order if a dog repeatedly barks, damages other people's property or chases people, animals or vehicles. The owner can be fine if a dog is deemed as a nuisance. If your neighbours are complaining because your dog barks too much, there are things you can do. Contact the Council for some helpful hints.

For further information please visit the Department of Local Government website. This website contains information and resources for dog and cat owners, breeders, pet shops, vets, authorised identifiers and councils in NSW.

Bushland

Our bushland is a precious resource. Please play your part to care for our native bushland.

- Don't dump garden rubbish into bushland or reserves.
- Don't remove bush rock, and plants.
- Keep your pets out of bushland areas.

Environmental Complaints – Noise, Air and Land Clearing

Council's Environmental Services Department works to ensure compliance with development consent and matters such as noise complaints, unauthorised land filling and dumping of rubbish on private property. Council is also responsible for enforcing siltation controls relating to development and other activities in the Shire.

Heritage

The unique heritage of Lockhart Shire is an undeniable asset of our region. With a number of heritage buildings located across the Shire, Council is committed to preserving the historical features of the area, and ensuring new development complements the existing landscape.

Fire Permits

During the bush fire period (usually November – March) all fires in the open require a permit. During fire danger periods no permits are issued. Residents are reminded to maintain their respective blocks and ensure growth is maintained at appropriate heights. Details of responsibility relating to fire permits contact Rural Fire Service (RFS) Office in Wagga Wagga on (02) 6363 8888.

Garbage Collection

Weekly Garbage Collection

Weekly garbage service in the townships of Lockhart, The Rock, Yerong Creek and Pleasant Hills is conducted early Wednesdays. Some rural ratepayers who have property entrances on the route taken by the garbage contractor have taken the opportunity to have a weekly garbage service by purchasing a big bin from Council. Only bins purchased from Council will be collected by the contractor. Big bins can be purchased by contacting Council.

Recycling Pick Up

Fortnightly recycling pick up in all towns and villages that have a weekly garbage service. Only bins purchased from Council will be collected by the contractor. Big bins can be purchased by contacting Council.

Annual Kerb Side Pick Up

Council conducts an annual kerb side pick-up service. This allows residents to have larger items of rubbish removed. Items for removal are placed on the kerb side and collected on a day nominated by Council.

Garbage Depot Fees and Charges

Information relating to garbage depot fees and charges can be found on council website www.lockhart.nsw.gov.au.

Trees

Council has a Street Tree Management Plan protecting vegetation in all public open space areas. Residents are advised to seek information from Council's Engineering department before planting or removing any vegetation on council land.

Water & Wastewater

Sewerage

Lockhart and The Rock are serviced by a sewerage system. Council is continuously undertaking maintenance works on water and sewerage systems to ensure cleanliness and continuity of service.

Water

Water throughout the townships in the Shire is supplied and administered by Riverina Water. Their head office is in Wagga Wagga. Problems with broken or leaking water pipes and water metres should be referred to Riverina Water on (02) 6922 0608.

Development

Building Services

A permit may be required before commencing any building work on your property including renovations, alterations or additions and before the erection of retaining walls, carports and swimming pools.

Getting Your Development Started

All development, whether building, subdivision or demolition requires the submission of a Development Application and the consent of Council subject to the relevant legislation and guidelines. If you intend to build or plan to develop or use your land in Lockhart Shire the first step is to see Council.

Council will be able to tell you:

- The rules for developing the particular site under Council's Local Environmental Plan.
- The development assessment process.
- Any issues they might know affecting your proposed development and use of the site.

Unapproved construction may require demolition.

Council's Environmental Services Department offers a comprehensive service for anyone wishing to obtain a Complying Development; Construction; Occupation or Subdivision Certificate and Council's Environmental Planning Office is available for pre-submission discussion.

Community Services

Aquatic Facilities

Lockhart Swimming Pool

Lockhart swimming pool provides a 6 lane pool and an undercover toddlers wading pool and is operational from November until March. The surrounding shady grassed area is equipped with BBQ's and is a popular place for birthday parties and get-togethers during the summer months. The centre caters for all age groups. Learn to swim classes, aqua fitness and various swimming and training squads operating each season.

The Rock Swimming Pool

The Rock swimming pool operates during the summer months and patronage by all interested people is welcomed. Community learn to swim classes are conducted in the summer months.

Community Services.

Aim to provide services to the frail aged and younger disabled living in their own homes as well as provide support to the rural and isolated suffering hardship and health issues. Services include Meals on Wheels, social support, life skills for disabled clients, community and non-emergency health related transport, Day Club, domestic assistance, respite and community access.

Riverina Regional Library

One of the largest regional library services in NSW provides library services to towns and villages in Lockhart Shire including Lockhart, The Rock, Milbrulong, Pleasant Hills and Yerong Creek. Further details, www.rri.nsw.gov.au.

Parks & Gardens

Council maintains parks and reserves throughout the Shire. Many of the parks and reserves offer a unique setting. Council aims to make the most of the community resources by encouraging residents and others in the community to take an active role in improving our parks. Many activities can be undertaken including design of parks, tree planting, bush regeneration and revegetation, park construction, landscaping.

Sporting Facilities

Lockhart Shire Council is responsible for the care, control, management and development of quality sporting facilities in the Shire, providing sporting opportunities to its wide range of clubs and associations and recreation facilities for the entire community. Use of these facilities is on a user pays basis.

Real Estate

Council actively encourages relocation to the Shire townships and has developed residential subdivisions in Lockhart and The Rock.

Tourism

Tourism plays an important part in Lockhart Shire. The helpful staff at the Lockhart Visitor Information Centre are available to answer all your tourism related enquiries. Lockhart Visitors Information Centre, open 7 days a week, is located at Green Street Lockhart, 02 69 205674.

Transport

- Lockhart airstrip – used for private and recreational use.
- Countrylink Bus services – Sunday, Monday, Wednesday and Friday from Lockhart. Ph.132232
- Community Transport - Lockhart and District Community Transport, services to Wagga Wagga and Albury. Ph: (02) 69204162
- Train Service - Countrylink XPT between Sydney and Melbourne will stop at The Rock on request. Bookings essential Ph.132232

Contact Details:

Lockhart Shire – Your Council

Lockhart Shire Council
65 Green Street
PO BOX 21
Lockhart NSW 2656

Ph: (02) 69205305
Email: mail@lockhart.nsw.gov.au
www.lockhart.nsw.gov.au

After hours phone service

Council's phone lines are open from 8.30am - 4.30pm Monday to Friday, after which a 24-hour emergency service is available by Ph: (02) 69205305