



AVONDALE PLACE

HENTY RESPITE TRUST LTD



Avondale Place

COMMUNITY CARE





CONTENTS

- 01 Strategic Plan**
- 02 2022-23 Strategic Priorities**
- 03 Proposed Building**
- 04 Community Engagement**
- 05 Funding**



01

STRATEGIC PLAN

Vision

Avondale Place will be a preferred centre for affordable retreat and respite for those in need of care and support for their carers.

Mission

To provide relief to people in need of either short term respite or assisted living that is fit-for-purpose in a safe, home-like environment within a small-town setting.

Values

CARE

Provide life enhancing care

COMPASSION

Needs sensitive approach

ETHICAL

Residents first, second & third

PARTNERSHIPS

Look beyond our own verandas



02

STRATEGIC PRIORITIES

2022-2023

01 CONSTRUCT

Complete construction of Avondale Place and independent living units.

- Select contractors
- Monitor construction
- Finalise appliances, furniture, and decorating
- Complete buildings
- Complete landscaping
- Building parking facilities

02 OPERATE

Engage a service provider to deliver on mission respecting Henty Respite values.

- Research details needed for service agreement, including length of agreement
- Negotiate and finalise agreement with service provider
- Identify key performance indicators
- Solicit feedback of client satisfaction
- Monitor service provider performance
- Summative evaluation mid-way through service agreement

03 FUND

Acquire, maintain, and consolidate funds to ensure the financial viability of Henty Respite Trust.

- Donations program – cash and in-kind
- Grants program – governments and private entities
- Fundraising program
- Establish a "giving" target
- Prepare operating and capital budgets
- Employ staff as required

04 ENGAGE

Engage the local community to embrace the opportunity for intentional care for those who need it.

- Intentional contact – community events to see the project
- Utilise 2021 survey results to find spaces to engage people
- Seek interest regarding volunteers and workforce
- Recruit volunteers to assist with delivering mission
- Utilise community communication opportunities, including word of mouth

05 COMMUNICATE

Develop and implement marketing and public relations plans.

- Website
- Local newsletters
- Press releases for key event
- Other media options (LAHC, Facebook)
- Content manager for communication products



HENTY COMMUNITY SURVEY RESULTS

Greater Hume Shire. Henty & Culcairn	1350
Lockhart Shire/Yerong Creek	670
Total number of surveys distributed	2020

Surveys Completed and Returned. (6.7%)

Henty	109	80% of total returns
Culcairn	19	14.5%
Lockhart/Yerong Cr.	21	15.5%
Total returned	137	

Respondents:

- 66.4% were 60 years & over
- 30.1% were aged between 19 & 59 years
- 66.4% were female
- 28.3% were male

37%

had either themselves or a family member access respite care in the past

23%

Unable to access respite care when required.

92%

Would access respite care if available and in Henty

HENTY COMMUNITY SURVEY RESULTS

Using Denominator of 118

69.2% or 82 respondents would require medium to low care respite.

62% or 73 respondents want one week to one month of care

15% or 18 respondents one or two days care

10% or 11 respondents one to two months

Balance one or two days

Frequency of use of respite care.

17.7% or 21 respondents would use respite on a regular basis

41.6% or 50 would use on occasional basis

13.7% or 16 infrequently

The biggest barrier currently faced by those seeking respite care,

45 location

31 said cost,

42 availability

17 unsuitable for particular need.

64
potential users

31
potential volunteers

5

interested in employment

62
carers

03

INFRASTRUCTURE

Council has approval granted to commence the construction works.

Commercial builder has been appointed, Premier Building & Construction

Current timeline indicates that the build will be complete late 2022.

The construction works will provide Henty with an additional health infrastructure valued at \$2M



Building Plans

The facility will encompass two forms of accommodation on a large site. A four-bedroom respite care center will accommodate one lot whilst four two-bedroom independent living units on the adjacent block.

Planning and design works have been completed with the intent to undertake construction simultaneously

The buildings will be in a carefully designed landscape to offer peace and tranquility and a sense of belonging to both the short term and longer-term residents.

All buildings will be constructed to meet the latest guidelines for respite and disability care while meeting sustainability and energy efficiency goals.

The construction works will provide Henty with an additional health infrastructure valued at \$2M

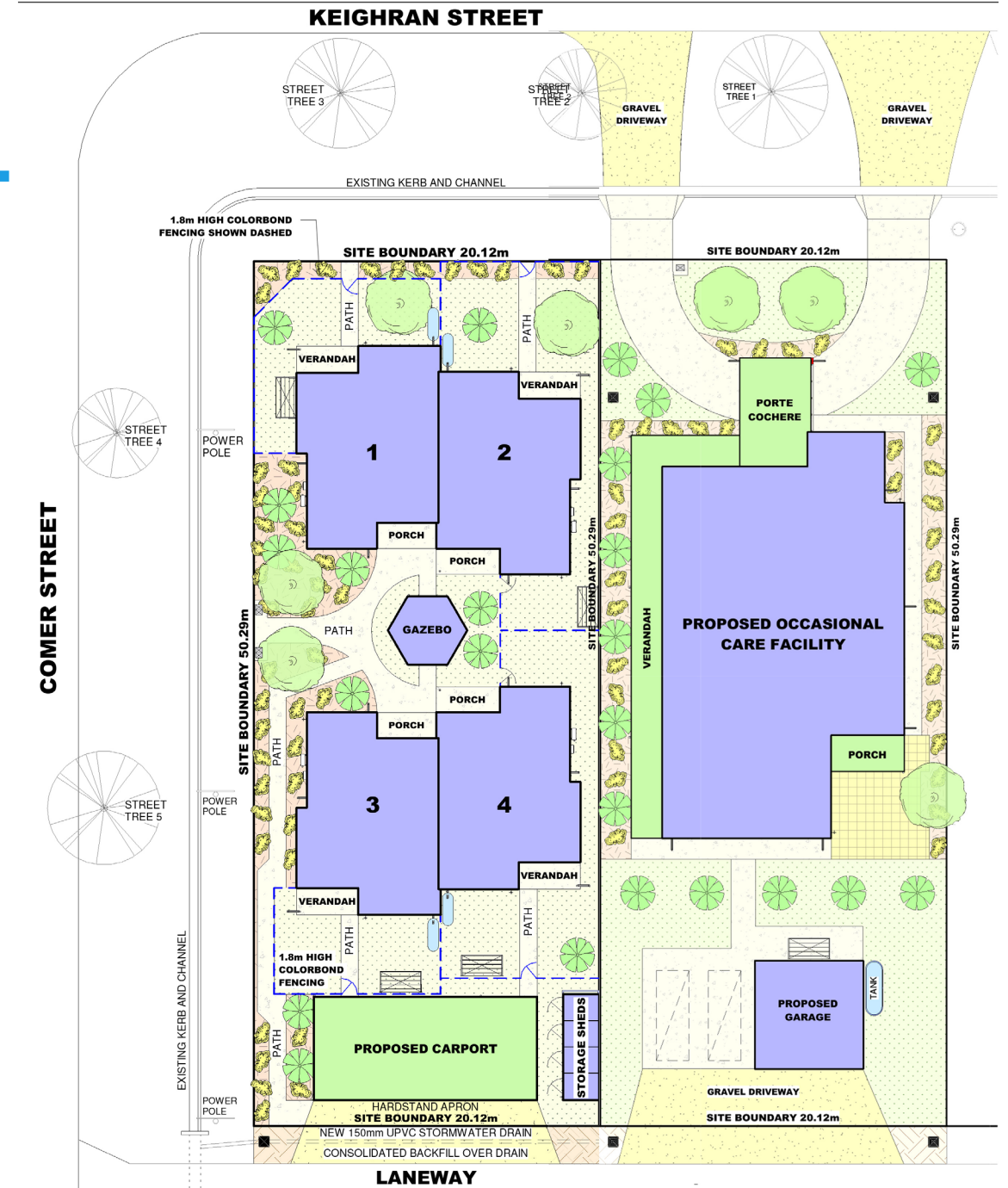

04

COMMUNITY ENGAGEMENT

Henty Respite Ltd is a community-driven and funded project aimed at delivering care to residents of the Greater Hume Shire and Lockhart Shire.

Our Board is voluntary, focused on supplying an accessible service to the greater community.

INFRASTRUCTURE

Provide \$2M of new health infrastructure

TRAINING

Providing recognized training for local residents

EMPLOYMENT

Present job opportunities for the local community

SERVICE

Provide professional accessible care locally



20 January 2022

Ben Hooper
Chair
Henty Respite Ltd

Dear Ben,

Please find this letter of support for Henty Respite Ltd as your organisation makes funding applications for Avondale Place.

Mercy Connect supports people in need to live fulfilled lives. We provide a range of services to support adults, children and older people with a disability to build skills and capability to ensure they can participate in leading a meaningful life. Mercy Connect is strategically located in regional areas Albury-Wodonga and Central West regional. We strongly believe in engaging and maintaining presence in our local communities with over 270 employees and providing support to over 150 participants.

Mercy Connect was recently awarded two community prestigious awards at the 2021 Albury-Wodonga Business Awards in the categories of Excellence in Health, Education and Disability and Outstanding Not for Profit Community Organisation. These acknowledgements are a clear affirmation of how Mercy Connect responds to local needs, in meaningful ways, despite ongoing diversity.

Supporting regional needs and our community is important to Mercy Connect. We are committed to provide ongoing commitment to other organisations, like Henty Respite Ltd who share the same values, ethos and mission. We are excited to work with your Board, team and community, to deliver and manage the proposed respite housing, Avondale Place, which will benefit people across the region and will reduce transportation challenges to access necessary support and services.

Further, it is our strong intention that, wherever possible, staffing will be recruited from within the local community and surrounds, with priority given to suitably qualified candidates.

We wish Henty Respite Ltd all the very best with any future funding submissions.

Together we grow,



Trent Dean
Chief Executive Officer
Mercy Connect

mercyconnect.org.au

Mercy Connect Limited
ABN: 45 075 648 378
NDIA Provider: 4050 003 084



05

FUNDING

Project initiated due to the extreme difficulty experienced by a local family requiring respite care for a member and Accompanied by a very generous donation to ensure that this dream, became a reality.

This is a project for the community, that is expected to cost in excess of \$2,000,000

PRELIMINARIES

Land purchase, legal fees, design and council fees

CONSTRUCTION

Building and landscaping costs

FURNISHINGS

Ensuring we deliver a comfortable living environment

ONGOINGS

Rates, Services, Maintenance



Budget

PRELIMINARIES	
Land Purchase	\$102,800
Design fees	\$39,997
Legal fees	\$12,800
Council fees	\$2,600
Section 7.12 Contribution	\$3,892
CONSTRUCTION	
Construction	\$1,893,550
Certifications/variations *	\$189,355
FURNISHINGS	
Allowance *	\$40,000
ONGOINGS / 12MONTHS	
Services*	\$7,200
Maintenance*	\$10,000
TOTAL	\$2,302,194
* indicates assumptions have been made.	
All other figures are accurate	



Funding

This is a major health project providing a health service that is otherwise unavailable to rural residents within Greater Hume, Lockhart & Federation Shires.

It is unusual for a project of this magnitude to such a large sum of money up front.

The project is facing difficulty in applying for the larger capitol infrastructure grants as doing so would delay the build buy at least 12 months.

We are asking for financial support to complete and deliver this facility to the community as soon as possible

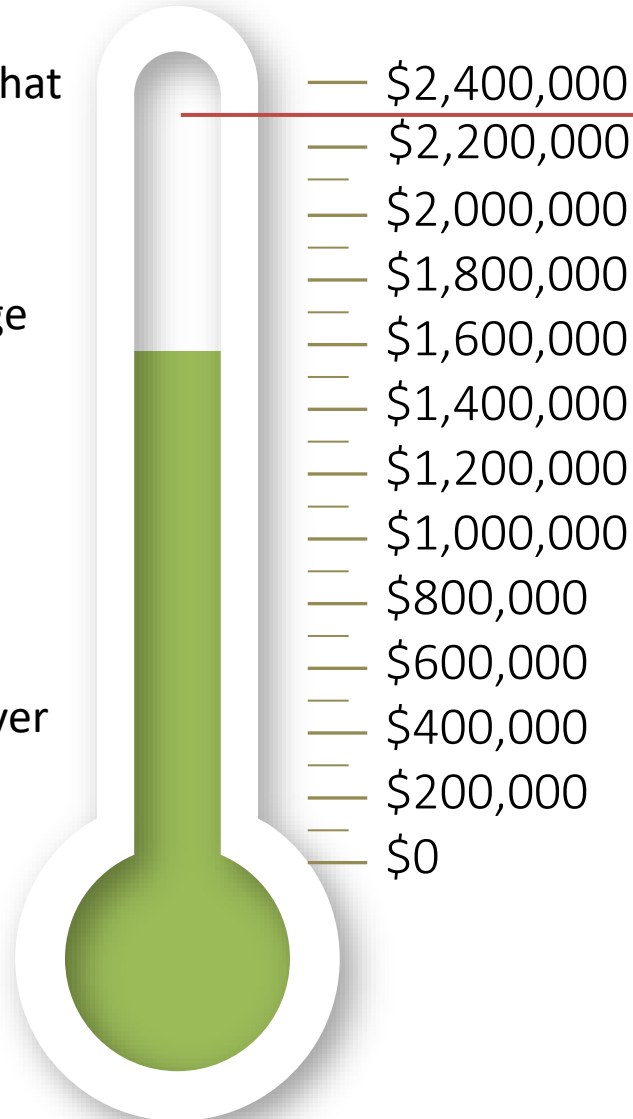

TOTAL PROJECT COST

25%

REQUIRED FUNDING

We are requiring an additional 25% [\$400,000] in order to cover outstanding building costs. Whilst there will be additional expenses throughout the development, we are confident that these can be raised from within the community.

75%

CURRENT FUNDING

Along with a generous initial donation assisted by donations from other community groups and individuals we currently have 75% of the estimated construction budget.



WHAT WE ASK OF YOU

01 PROMOTION

Raising awareness of our project within your communities

02 COMMUNITY ENGAGEMENT

Encouraging ambassadors, advocates and those seeking employment to contact us

03 FUNDING

Financial support and assistance with grant funding

